

TECHNICAL DATA

Specifications		50/50CS	70	100
Thermal output (burnt)	kW	23	30	35
Power output	kW	18	23	27
Overall efficiency	%	78,2	78,4	78
Efficiency to the water	%	~ 70	~ 70	~ 70
Optimal wood consumption	kg/h	5,5	7	8
Total weight including the packaging (min-max)	kg	171/189	184/230	251/302
ø female smoke outlet	cm	18	20	25
ø stainless steel chimney flue for a height ranging from 3 to 5 m	cm	20	25	25
ø stainless steel chimney flue for a height ranging from 5 to 7 m	cm	18	22	25
ø stainless steel chimney flue for a height exceeding 7 m	cm	18	20	22
ø external air inlet	cm	10	10	10
Water capacity	litres	60	70	90
Maximum operating pressure	bar	1,5	1,5	1,5
Hot sanitary water production (kit 1-3-n3-n3bis-6)*	l/min**	10	12	14
Heating capacity ***	m ³	440	560	660
System return	inches	1"	1 1/4"	1 1/4"
System flow	inches	1"	1 1/4"	1 1/4"

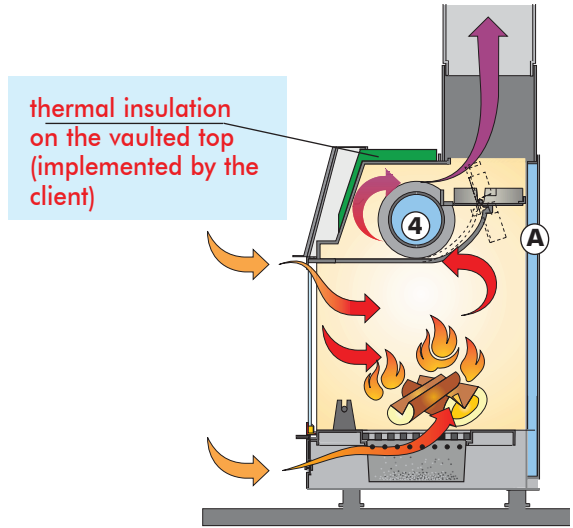

The fireplace must be installed with an open tank (EXCEPT FOR IDRO 50/CS).

The water of the radiator circuit warms up, circulates in the heat exchanger pipe (4) and the hollow space (A) and skims along the semi-circular wall. The hollow space is created by using thick steel sheet metal.

* boiler temperature is 70°

** ($\Delta T = 25K$)

*** Insulation in accordance with the Legislative Decree 192/2005 ex Italian Law 10/91 and subsequent changes together with an expected heat output of 35 Kcal/m³ per hour.

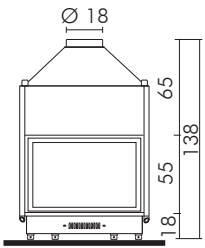

**IDRO 50
IDRO 50 CS
fixed door
leaf**

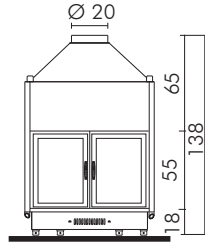

**IDRO 70
fixed door
leaves**

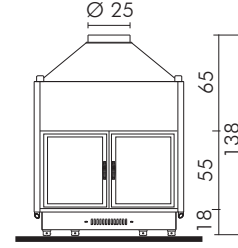

**IDRO 100
fixed door
leaves**

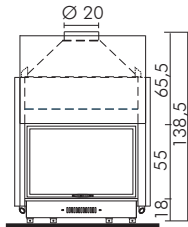
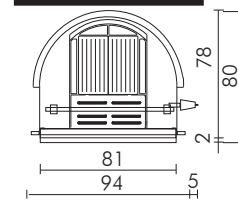
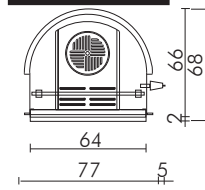
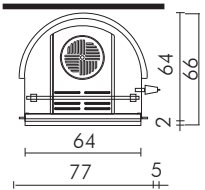

**IDRO 70
door**

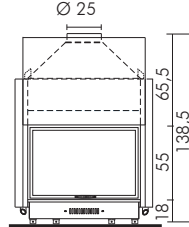

**IDRO 100
door**

